

# STEP-BY-STEP GUIDE FOR DRAWING & MEASURING YOUR KITCHEN

by Aqua Kitchen & Bath Design Center NJ



## DRAW AN OUTLINE



Do not include current cabinetry or any other furniture that will not be kept. All of the measurements should be in inches.

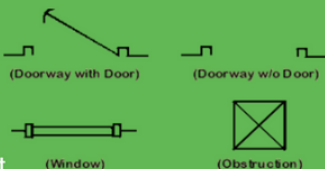

Use these symbols in your drawing for doors and windows.



Draw in obstructions: pipes, sink plumbing, ceiling soffits, refrigerator, and dishwasher hook-ups that won't be moved.

## START WITH THE DETAILS



Begin at the top left corner to the first window, door, wall. Go clockwise around the room until each wall, window, door has been measured.



Measure the ceiling height. Note it in the center of your drawing. Ceiling heights can vary by a few inches.



Measure from the floor to the bottom of each window and also measure the overall window height.

## MARK YOUR MEASUREMENTS



Label the windows, doors, walls, and write the name of the adjacent rooms. Mark them as: "Window 1", "Door 2", "exterior wall", etc. Use the following example as a guideline.

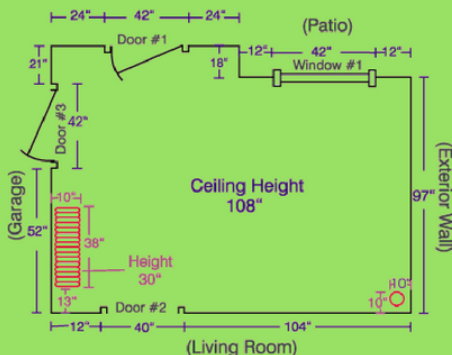

## MEASURE THE OBSTRUCTIONS



Measure obstructions: walls, pipes, etc. that you either cannot, or do not want moved. If it's close to the wall, measure from the wall to the edge of the obstruction.



Measure from the second closest wall to the edge of the obstruction. If it doesn't span the full height, measure the obstruction's height.



Check the measurements. If the room is rectangular add the measurements of the parallel walls and make sure they match or are close.

FOR MORE DETAILS, PLEASE CONTACT US  
[AQUAGRANITE.COM/CONTACT](http://AQUAGRANITE.COM/CONTACT)